

# Memorandum

To: Jon A. Bisher - City Manager  
From: Adam C. Hoff, P.E. - City Engineer <sup>ACH</sup>  
cc: Brent Damman, David Grahn, Bob  
Weitzel  
Date: July 7, 1999  
Subject: Kinder Kampus Driveways

1232 Scott

Attached is an estimate and a sketch for a revised drop-off area for preschoolers at the Kinder Kampus Day Care Center. The proposed improvements would consist of widening both the northerly and southerly drive approaches such that a large school bus could pull off onto the Kinder Kampus property, rather stop in the street. The northerly approach will need to be widened by twenty (20) feet and the southerly entrance by ten (10) to fifteen (15) feet. The plantings located immediately adjacent to the sidewalk will need to be removed. The estimates reflect both paved and unpaved areas.

As I stated before, it is my opinion that the City should not contribute any money to this project. I believe that it is the responsibility of the owners to maintain their site. If they choose not to do so, the bus stop should be moved roughly 300 feet to the north.

If you have any questions or require additional information, please see me.

City of Napoleon, Ohio  
**Kinder Kampus Day Care Center**  
**Drive Approach Widening**

Item No.	Description	Quantity	Unit	Price	Total
<b>Paved Bus Pull-Off:</b>					
1	Excavation	155.00	c.y.	\$2.50	\$387.50
2	Subgrade Compaction (incl. Driveway)	370.00	s.y.	\$1.50	\$555.00
3	Cut Type 2 Concrete Curb & Gutter	30.00	l.f.	\$8.50	\$255.00
4	10" Aggregate Base - ODOT 304 (Pavement)	93.00	c.y.	\$30.00	\$2,790.00
5	8" Aggregate Base - ODOT 304 (Driveway)	8.00	c.y.	\$30.00	\$240.00
6	3-1/2" 402 Asphalt Concrete	32.50	c.y.	\$100.00	\$3,250.00
7	1-1/2" 404 Asphalt Concrete	14.00	c.y.	\$105.00	\$1,470.00
8	Bituminous Prime Coat (0.40 gal. per s.y.)	148.00	gal.	\$1.50	\$222.00
9	8" Concrete Drive Approach	35.00	s.y.	\$45.00	\$1,575.00
10	6" Concrete Sidewalk (incl. stone base)	80.00	s.f.	\$5.00	\$400.00
<b>Subtotal:</b>					<b>\$11,144.50</b>
Contingencies:					\$1,855.50
<b>TOTAL:</b>					<b>\$13,000.00</b>
<b>Unpaved Bus Pull-Off:</b>					
1	Excavation	16.00	c.y.	\$2.50	\$40.00
2	Subgrade Compaction (incl. Driveway)	35.00	s.y.	\$1.50	\$52.50
3	Cut Type 2 Concrete Curb & Gutter	30.00	l.f.	\$8.50	\$255.00
4	10" Aggregate Base - ODOT 304 (Pavement)	0.00	c.y.	\$30.00	\$0.00
5	8" Aggregate Base - ODOT 304 (Driveway)	8.00	c.y.	\$30.00	\$240.00
6	3-1/2" 402 Asphalt Concrete	0.00	c.y.	\$100.00	\$0.00
7	1-1/2" 404 Asphalt Concrete	0.00	c.y.	\$105.00	\$0.00
8	Bituminous Prime Coat (0.40 gal. per s.y.)	0.00	gal.	\$1.50	\$0.00
9	8" Concrete Drive Approach	35.00	s.y.	\$45.00	\$1,575.00
10	6" Concrete Sidewalk (incl. stone base)	80.00	s.f.	\$5.00	\$400.00
<b>Subtotal:</b>					<b>\$2,562.50</b>
Contingencies:					\$437.50
<b>TOTAL:</b>					<b>\$3,000.00</b>

ADJUSTED BY THE  
OF NAPOLEON

Y CLEANERS

INSURANCE  
BUSINESS

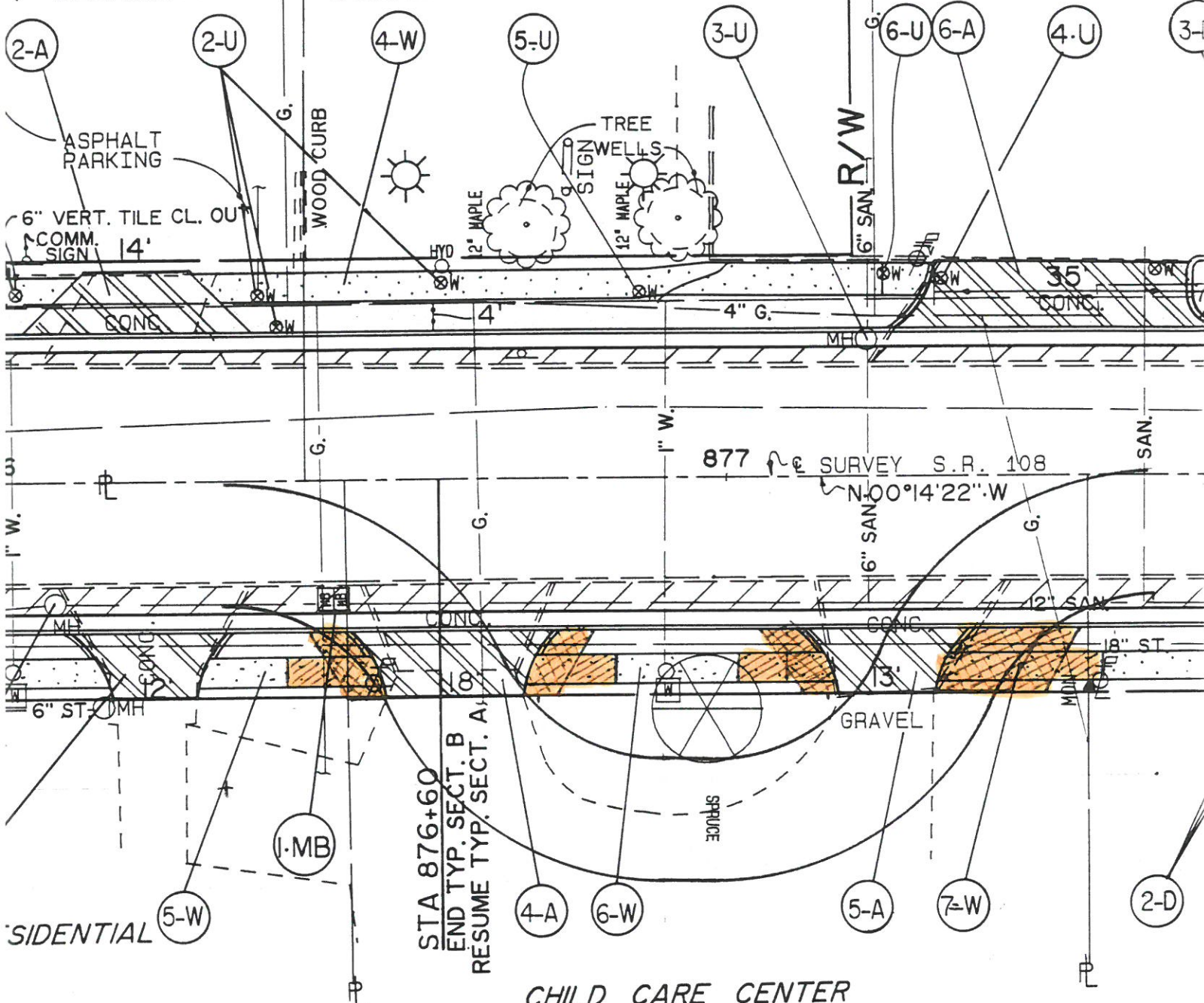

SIDENTIAL

STA 876+60  
END TYP. SECT. B  
RESUME TYP. SECT. A

CHILD CARE CENTER

. 875+58.74 (AHEAD)  $\phi$  SURVEY  
. 875+49.35 (BACK)  $\phi$  CONSTR.

677.53*	677.94	678.10	679.01	680.03*
	+50			+50